

Instructions for Use

830011001 Brass Manifold for Manufacturers and Service Stations

Cat. No.: 830011001, 830010101, 830013001, 830014001,
830AOE, 830AOEU, 833AOI, 8491AM, 8492AM, 830AOISC, 831AOISCLN

Cautions:

- To prevent valve damage, Follow proper torque settings.
- Carefully follow the directions below to maintain the valve integrity.

Installation 840 Inflator (ill. 1):

1. Install valve core (P/N 832AO) in manifold and torque to 1.5 - 2 in-lb., with a calibrated torque wrench.
2. Install bottom gasket (P/N 8492AM) on manifold until it is retained in groove. * Note always use new gaskets when installing inflator.
3. Install 840 inflator on manifold, aligning flats.
4. Install top gasket (P/N 8491AM) on manifold.
5. Screw cap on manifold.
6. Retain (secure) inflator and torque Cap to 24 - 30 in-lb., with a calibrated torque wrench.

Installation Alpha Inflator® (ill. 2):

1. Install valve core (P/N 832AO) in manifold and torque to 1.5 - 2 in-lb., with a calibrated torque wrench.
2. Check inflator to make sure o-rings are installed on both sides.
3. Install Alpha Inflator® on manifold, aligning flats.
4. Screw cap on manifold.
5. Retain (Secure) Inflator and torque cap to 24 - 30 in-lb. with a calibrated torque wrench.

Installation 1F Inflator® (ill. 3):

1. Install valve core (P/N 832AO) in manifold and torque to 1.5 - 2 in-lb., with a calibrated torque wrench.
2. Check inflator to make sure o-rings are installed on both sides.
3. Install 1F Inflator® on manifold, aligning flats.
4. Screw cap on manifold.
5. Retain (Secure) Inflator and torque cap to 24 - 30 in-lb. with a calibrated torque wrench.

Illustration 1

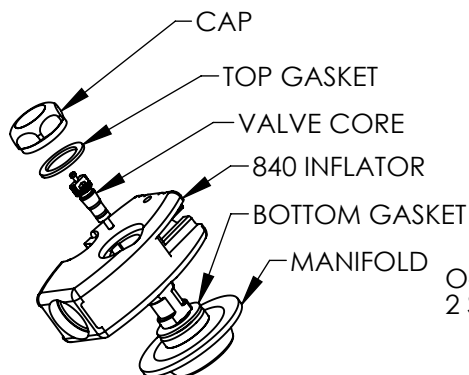

Illustration 2

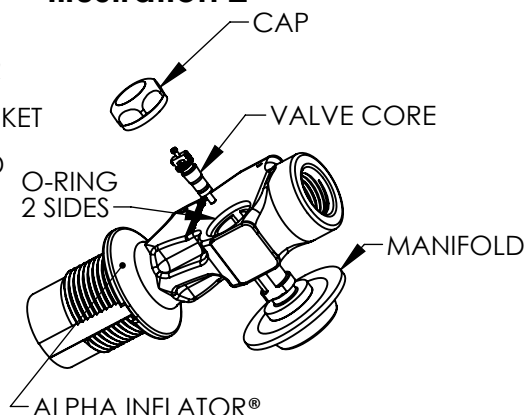
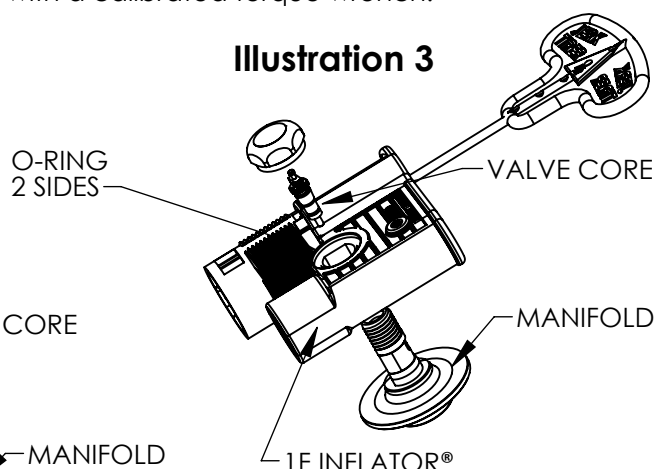

Illustration 3



Halkey-Roberts®

2700 Halkey-Roberts Pl. N.
St. Petersburg, FL 33716 USA
727.471.4200
www.halkeyroberts.com
sales@halkeyroberts.com